



香港中文大學圖書館

The Chinese University of Hong Kong Library

Library Orientation for Postgraduate Students

研究生圖書館迎新講座

Ms. Bernice Chan
Postgraduate Liaison Librarian
Learning Services

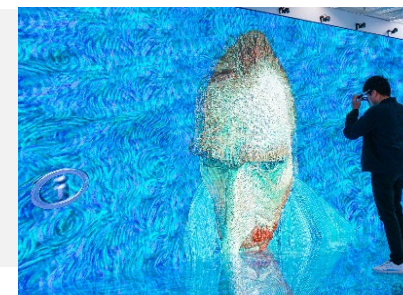

Agenda

- Introduction to CUHK Library 中大圖書館簡介
- Library Resources, Services and Facilities for Postgraduate Students
研究生可使用的圖書館資源，服務及設施
- Research Support 研究支援
- Postgraduate Workshop Series 研究生講座與研習班





Introduction to CUHK Library



CU Link Card, Login ID and Password

中大通、登入ID 及密碼

- **Student CU Link Card = Library Card**
中大通 (學生證) = 圖書證
 - Access to CUHK libraries 進入圖書館
 - Borrow library materials 借閱
- Login to access Library's e-resources off campus, book room, renew book, and to use library PCs
登入使用：遙距取用電子資源、預訂研讀室、續借圖書及圖書館的公用電腦

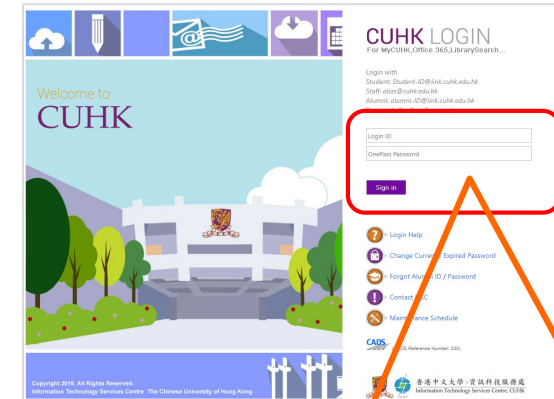

Login 登入: Student_ID@link.cuhk.edu.hk
Password 密碼: OnePass Password
 (a single login across CUHK online systems)



Library homepage 圖書館主頁

香港中文大學圖書館
The Chinese University of Hong Kong Library

Quick Link A A A 繁|簡

Libraries Using the Library Collections Research Support Learning Support About the Library Help

LibrarySearch | Databases | Journals | ReadingList / Course Reserves | Exam Papers | Theses & Dissertations | Special Collections

Enter search terms All [Advanced Search](#) | [Help](#)

[● HKALL](#)
[● New Additions](#)
[● A-Z Subject Guides](#)
[● EndNote](#)
[● RefWorks](#)
[● My Library Record](#)

[Today's Hour](#)
[PC Availability](#)
[Opening Hours Calendar](#)

▼ University Library	09:00 am - 07:00 pm	▼ Chung Chi Library	Closed	▼ Architecture Library	24/7
Learning Garden	24/7	▼ New Asia Library	09:00 am - 07:00 pm	▼ Law Library	09:00 am - 07:00 pm
Special Collections	09:00 am - 05:30 pm	▼ United College Library	09:00 am - 07:00 pm	▼ Medical Library	24/7
Learning Commons(WMY)	09:00 am - 05:30 pm				



<https://www.lib.cuhk.edu.hk>



Exploring the Library homepage 探索圖書館主頁

- Libraries
- Using the Library
- Collections
- Research Support
- Learning Support
- About the Library
- Help

- University Library
 - Learning Garden and MakerSpace
 - Digital Scholarship Lab
 - Special Collections
 - CUHK History Gallery
- Architecture Library
- Chung Chi College Elisabeth Luce Moore Library
- Learning Commons (WMY)
- New Asia College Ch'ien Mu Library
- United College Wu Chung Library
- Li Ping Medical Library
- Lee Quo Wei Law Library
 - Legal Resources Centre

Home > Libraries

University Library

test

About Us



The University Library houses extensive collections including Special Collections, Hong Kong Studies Collection, Arts and Humanities Collection, Business Collection, Engineering Collection, Science Collection, Social Sciences Collection, the Reference Collection, General Education Collection and Good Reads. Access to the Law Library is via the University Library.

It is the largest of all the CUHK Libraries with a wide range of facilities – over 2,400 study seats and more than 230 computer terminals. For individual quiet study it offers the Reference Reading Room, Faculty Study rooms, Doctoral Study Rooms, as well as quiet study space on the upper floors. For those seeking collaborative study space there are Group Study Rooms and the Learning Garden. The Learning Garden is open 24/7 during semesters. The Library is a technology-rich, versatile study space and includes the CUHK Library exhibition space which holds regular exhibitions focusing on CUHK Library collections.

The University Library also plays a crucial role in connecting CUHK users with scholarly resources available elsewhere in Hong Kong and in the world. It manages the Hong Kong Academic Library Link (HKALL) and the Interlibrary Loan services. In addition, application for JULAC Library Card and any request for CUHK Library needs to be made at the University Library.

The University Library was established in 1965 and was originally located in the On Lee Building in Kowloon. In August 1969, it moved to temporary quarters in the Benjamin

Today Opening Hour

9am - 7pm

Contact

(852) 3943 7305
library@cuhk.edu.hk

Location

- Location
- Floor Plan**
- Collections
- Virtual Library Tour G/F
- Virtual Library Tour 1/F



Opening hours 開放時間

香港中文大學圖書館
The Chinese University of Hong Kong Library

Quick Link ▾ 繁體中文 簡體中文

Libraries Using the Library Collections Research Support Learning Support About the Library Help

LibrarySearch | Databases | Journals | ReadingList / Course Reserves | Exam Papers | Theses & Dissertations | Special Collections

Enter search terms All Advanced Search | Help

● HKALL ● New Additions ● A-Z Subject Guides ● EndNote ● RefWorks ● My Library Record

Today's Hour PC Availability **Opening Hours Calendar**

University Library	09:00 am - 07:00 pm	Chung Chi Library	Closed	Architecture Library	24/7
Learning Garden	24/7	New Asia Library	09:00 am - 07:00 pm	Law Library	09:00 am - 07:00 pm
Special Collections	09:00 am - 05:30 pm	United College Library	09:00 am - 07:00 pm	Medical Library	24/7
Learning Commons(WMY)	09:00 am - 05:30 pm				

Library	Opening Hour
University Library <ul style="list-style-type: none"> Learning Garden USC Collection Special Collections Digital Scholarship Lab 	08:20 am - 10:00 pm <ul style="list-style-type: none"> 24/7 08:20 am - 10:00 pm 09:00 am - 05:30 pm 08:20 am - 10:00 pm
Chung Chi Library <ul style="list-style-type: none"> G/F Reading Room 	08:20 am - 10:00 pm <ul style="list-style-type: none"> 24/7
New Asia Library <ul style="list-style-type: none"> LG/F 	08:20 am - 10:00 pm <ul style="list-style-type: none"> 24/7
United College Library <ul style="list-style-type: none"> LG/F 	08:20 am - 10:00 pm <ul style="list-style-type: none"> 24/7
Architecture Library <ul style="list-style-type: none"> Opening hours Staffed services 	24/7 <ul style="list-style-type: none"> 07:30 am - 10:00 pm 11:00 am - 07:00 pm
Law Library <ul style="list-style-type: none"> Legal Resources Centre Staffed services (LRC) 	08:20 am - 10:00 pm <ul style="list-style-type: none"> 09:00 am - 08:00 pm 09:00 am - 06:45 pm
Medical Library <ul style="list-style-type: none"> Staffed services 	24/7 <ul style="list-style-type: none"> 09:00 am - 07:00 pm
Learning Commons(WMY)	Opens at 10:00 am



LibrarySearch 檢索易

LibrarySearch provides a single access point to find articles, books and other resources, but not all of the library subscribed e-resources and research databases. If you need more specific information on a particular subject, it is better to search the [library databases](#).

LibrarySearch 提供了一個單一點來查找文章、書籍和其他資料，但並非所有圖書館訂閱的電子資源和資料庫都可以在LibrarySearch搜尋得到。如果您需要特定主題的資料，可搜索[圖書館資料庫](#)。

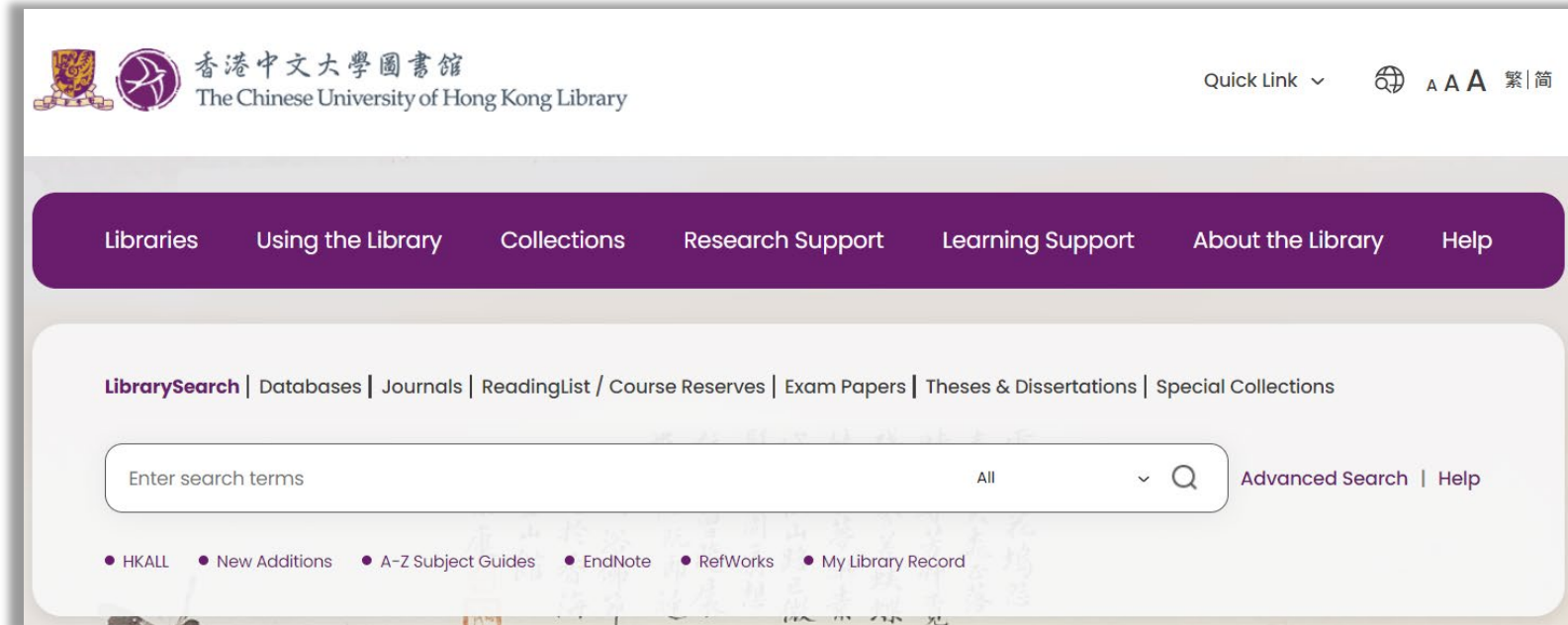

The screenshot shows the LibrarySearch website interface. At the top left, there is the logo of The Chinese University of Hong Kong Library, which includes the university crest and the text "香港中文大學圖書館" and "The Chinese University of Hong Kong Library". To the right of the logo, there is a "Quick Link" dropdown menu, a globe icon, and text "A A A 繁|簡". Below the logo and navigation is a dark purple horizontal bar containing several menu items: "Libraries", "Using the Library", "Collections", "Research Support", "Learning Support", "About the Library", and "Help". Below this bar is a white search area with a navigation menu: "LibrarySearch | Databases | Journals | ReadingList / Course Reserves | Exam Papers | Theses & Dissertations | Special Collections". The search area contains a search input field with the placeholder text "Enter search terms", a dropdown menu set to "All", a search button with a magnifying glass icon, and links for "Advanced Search" and "Help". At the bottom of the search area, there is a row of links: "● HKALL", "● New Additions", "● A-Z Subject Guides", "● EndNote", "● RefWorks", and "● My Library Record".



LIBRARY RESOURCES 圖書館資源



Library Resources 圖書館資源

- **E-resources 電子資源**

- 980+ databases 電子資料庫
- 180K+ e-journals 電子期刊 (種)
- 5M+ e-books 電子書

- **Printed materials 館藏**

Books, journals, newspapers, etc. 書、期刊、報紙等

- 2.7M+ print volumes (冊)

- **Others 其他**

- Audio-visual materials 視聽資料
- Microfilms, etc. 顯微膠片等



Collections 館藏

- Location of Collections 館藏分佈
<https://www.lib.cuhk.edu.hk/en/collections/location>
- Subject Collections 學科館藏
<https://www.lib.cuhk.edu.hk/en/collections/subject>



Arts and Humanities
Collection
文學與人文館藏



Business Collection
商科館藏



Education Collection
教育館藏



Engineering
Collection
工程館藏



Law Collection
法律館藏



Medical Collection
醫學館藏



Science Collection
理科館藏



Social Science
Collection
社會科學館藏



General Education
Collection
通識教育館藏

Special Collections 特藏

Some significant collections 重要收藏舉例

- Hong Kong Literature 香港文學
- Daoist Texts 道教經典文庫
- Bei Shan Tang Collection 北山汲古：利氏北山堂贈中國古籍善本
- Manuscripts of contemporary Chinese writers and poets such as Gao Xingjian and Bei Dao 中國作家手稿,例如高行健和北島
- Archival materials of David Hawkes 霍克思文獻
- Maurice and Judith Freedman Papers 傅利曼伉儷文獻
- Rulan Chao Pian Collection 卞趙如蘭特藏
- Chinese Medicine Texts Collection 中醫古典文庫
- United College Oracle bones 聯合書院甲骨
- Postbills of Cantonese Opera 粵劇戲橋



Archival Collections

檔案館藏



Manuscripts

手稿



Rare Books

善本書



Details: <https://lib.cuhk.edu.hk/en/collections/spc>



LibrarySearch 檢索易

LibrarySearch provides a single access point to find articles, books and other resources, but not all of the library subscribed e-resources and research databases. If you need more specific information on a particular subject, it is better to search the [library databases](#).

LibrarySearch 提供了一個單一點來查找文章、書籍和其他資料，但並非所有圖書館訂閱的電子資源和資料庫都可以在LibrarySearch搜尋得到。如果您需要特定主題的資料，可搜索[圖書館資料庫](#)。

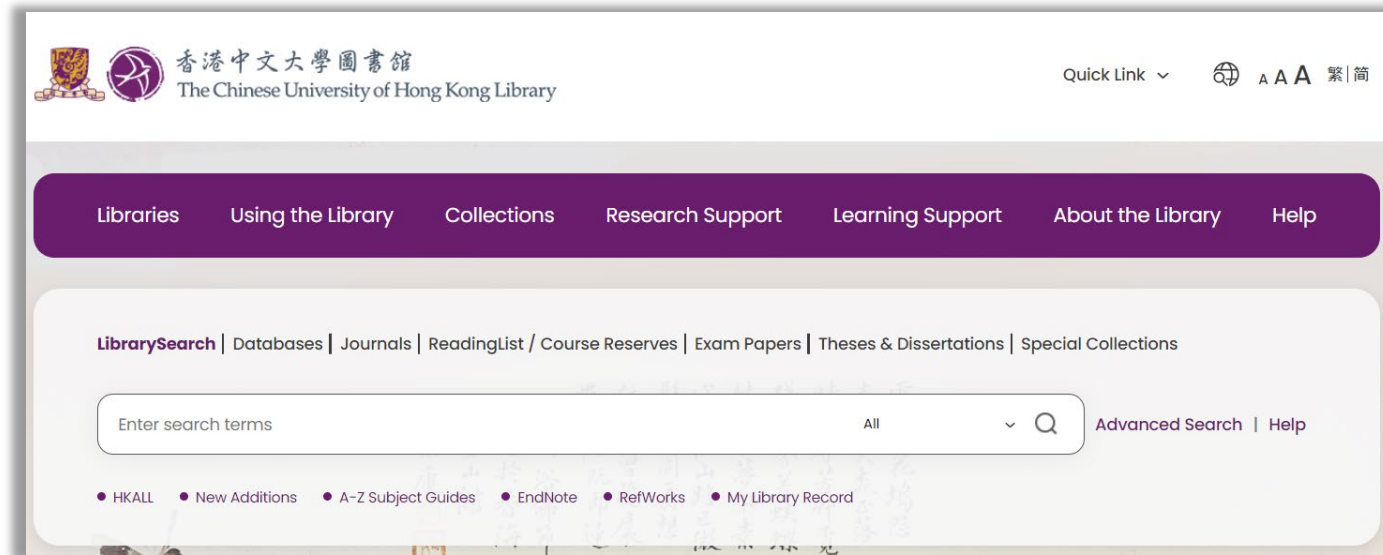

How to Use LibrarySearch: <http://libguides.lib.cuhk.edu.hk/howtouseLibrarySearch>



Highlights of “How-to” Guides 資源使用指引

- How to Find Books: <https://youtu.be/WdZgT5zIoac>
- How to Find eBooks: <https://youtu.be/sGZULqPxcf8>
- How to Find Articles <https://youtu.be/vcUt21gStJA>
- How to Find Journals: <https://youtu.be/gbIIPt63AxE>
- How to Use Advanced Search: <https://youtu.be/2sQWu3goAxI>
- How to Find CUHK Theses: <https://youtu.be/zPoyJL2TjKI>

How to Find eBooks

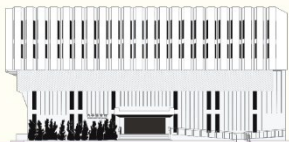

香港中文大學圖書館
The Chinese University of Hong Kong Library

How to Find Articles



香港中文大學圖書館
The Chinese University of Hong Kong Library

How to Find CUHK Theses

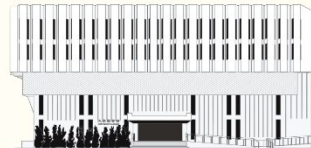

香港中文大學圖書館
The Chinese University of Hong Kong Library

How to Use Advanced Search

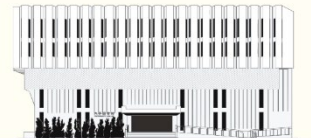

香港中文大學圖書館
The Chinese University of Hong Kong Library



Useful “How-to” guides: <https://libguides.lib.cuhk.edu.hk/Howtoguides>



Databases 資料庫

Databases by Subject 按科目分類的資料庫

Databases by Type 按種類分類的資料庫

The Chinese University of Hong Kong Library / LibGuides / Databases by Subject / Home

Databases by Subject: Home

Databases by Subject

Anthropology	Architecture	Art	Business
Career Information	Chemistry	Chinese Language and Literature	Chinese Medicine
Chinese Studies	Computer Sciences	Cultural Studies and Management	Data Science and Policy Studies
Economics	Education	Engineering	English Language and Literature
Evidence-Based Medicine	Film	Food Science	Gender Studies
Geography	Global Studies	History	Hong Kong Studies
Hotel & Tourism Management	Humanities	Interdisciplinary Resources	Japanese Studies
Journalism & Communication	Languages & Literature	Law	Life Sciences
Mathematics & Statistics	Medicine	Music	Nursing
Pharmacy	Philosophy	Physics	Politics
Psychology	Public Health	Religious Studies	Science (General)
Social Science (General)	Social Work	Sociology	Sport Sciences
Translation	Urban Studies		

Useful Links

- Databases [by Title (A-Z)]
- Databases [by Subject]
- Databases [by Type]

Databases by Major Web Gateway

- CUHK Examination Papers Database
- EBSCOhost Business Source Ultimate
- IEEE Xplore
- JSTOR
- Ovid Emcare
- Oxford Reference Online Premium
- Oxford Scholarship Online
- Project MUSE
- ProQuest
- Routledge/Taylor&Francis - InformaWorld
- ScienceDirect Books
- SpringerLink Books
- Web of Science
- Wiley Online Library
- WRDS
- 中國期刊全文数据库 China Journal Net (CJN)
- 萬方數據 WanFang Data
- 香港文學資料庫
- 香港中文期刊論文索引 HKInChiP

The Chinese University of Hong Kong Library / LibGuides / Databases by Type / Home

Databases by Type: Home

Databases by Type

Types A-Z

- Article Databases
- Bibliographies
- Biographies
- Book Reviews
- Case Law & Legislation
- Citation Reports
- Company Financial / Investment Data
- Directories
- Dissertations & Theses
- E-Book Collections
- E-News
- EBM Reviews
- Economic & Social Data
- Encyclopedias & Dictionaries
- Image / Sound Databases
- Patents & Standards
- Tests & Measurement Instruments
- Treatises
- Yearbooks



Databases by Subject : <https://libguides.lib.cuhk.edu.hk/DBbySubject>
 Databases by Type: <https://libguides.lib.cuhk.edu.hk/DBbyType>



Important Dissertations Databases

博碩士論文資料庫

- CUHK Electronic Theses and Dissertations Collection (ETD)
香港中文大學博碩士論文庫
- Digital Dissertation Consortium
- ProQuest Dissertations & Theses A&I
- 中國博士學位論文全文數據庫
- 中國優秀碩士學位論文全文數據庫
- 萬方數據：中國學位論文庫



Workshops 圖書館講座

Finding Theses and Dissertations in Your Research Area 搜尋研究領域的學位論文

<https://www.lib.cuhk.edu.hk/en/learning/pg-researcher-faculty-workshops>



Off-Campus Access to E-Resources

遙距取用電子資源

Off-campus access to Library's subscribed e-resources using Easy Access
使用 Easy Access 可遙距連結圖書館訂閱之電子資源

- No configuration on your PC or web browser is needed.
不需要配置您的電腦或瀏覽器。
- Simply click on any URL with the e-resources and login with CUHK Login.
使用校外電腦時，你只需點擊任何電子資源之連結，透過 CUHK Login 登入，便可以連結到圖書館的電子資源。



Off-Campus User Authentication
The off-campus access to e-resources subscribed by the Chinese University of Hong Kong Library is restricted to current CUHK students, faculty or staff.

Security reminder
Please remember to close all your browsers before leaving your computer.

Please click to login :

CUHK LOGIN

- ⊗ Excessive Downloading Prohibited
- ⊗ Easy Access for Digital Library Service for Alumni (DLSA)
- ⊗ What is Easy Access?
- ⊗ What is my login ID and password?

© The Chinese University of Hong Kong Library



Details: <https://www.lib.cuhk.edu.hk/en/use/off-campus>



LIBRARY SERVICES 圖書館服務



Borrowing 借閱

The screenshot shows the library's website interface. At the top, there is a navigation bar with the library's name in Chinese and English, a 'Quick Link' dropdown, and accessibility icons. Below this is a main menu with several categories: 'Libraries', 'Using the Library' (highlighted with an orange box), 'Collections', 'Research Support', 'Learning Support', 'About the Library', and 'Help'. Under the 'Using the Library' category, there are several sub-sections: 'Joining the Library', 'Opening Hours', 'Places to Study', 'Computing Facilities', 'Borrowing' (highlighted with an orange box), and 'Interlibrary Loan'. The 'Borrowing' sub-section lists several options: 'Borrow', 'Renew', 'Holds & Recalls', 'Return', 'Course Reserves', 'My Library Record', and 'More'.

- Borrowing quota and load period 借閱限額及借閱期限
- My Library Record 我的借閱記錄
- Renew 續借
- Return 歸還
- Holds & Recalls 預約及催還
- Email notifications 電郵通知書



Details: <https://www.lib.cuhk.edu.hk/en/use/borrowing>



Borrowing Quota and Loan Period 借閱限額及借閱期限

User type 讀者類別	Borrowing quota and loan period 借閱限額及借閱期限 #							
	Total Number of Items 資料總數	Books 書籍		Journals 期刊			Multimedia Materials 多媒體資料	
		Initial loan period 最初借期	Maximum loan period 最長借閱期限	Bound issues 合訂期刊		Current/Single issues 現期/單本	Initial loan period 最初借期	Maximum Loan period* 最長借閱期限
				Initial loan period 最初借期	Maximum Loan period* 最長借閱期限			
Postgraduate students 研究生	200	120 days	Unlimited renewals *	14 days	28 days	1 day	7 days	21 days

Return alert via email. Please always check your mailbox!

* Except for HKALL /ILL /non-renewable items or items that are being recalled or requested by other users, loans will be automatically renewed. 除港書網、館際互借資料或已被其他讀者催還或預約之資料外，借出的資料均會自動續借

All items are subject to recall. 所有借出資料或會被催還。

<https://www.lib.cuhk.edu.hk/en/use/borrowing/hold-recall#WhatIsRecall>



Details: <https://www.lib.cuhk.edu.hk/en/use/borrowing/borrow>



Borrowing 借閱

- My Library Record 我的借閱記錄
- Return 歸還
 - Borrowed items must be returned on or before the due date.
借出資料須在到期日或之前歸還到圖書館。
 - Interlibrary loan items, in-house use items and library equipment have to be returned to the Service Counter from which they were borrowed.
館際互借資料、館內使用資料及圖書館設備必須歸還到借出之服務櫃檯。
 - Other CUHK library materials can be returned to any CUHK Library.
其他中文大學圖書館資料均可歸還至任何一所中大圖書館。
 - Items borrowed via HKALL can be returned at the Service Counter of any CUHK Library.
透過港書網借閱之書籍可歸還至任何一所中大圖書館的服務櫃檯。
 - Book drop is also available at the following locations 還書箱亦設於下列地點：
 - Kuo Mou Hall, Shaw College 逸夫書院國楨樓
 - Yasumoto International Academic Park (1/F) 康本國際學術園 (一樓)



Borrowing 借閱

- Holds & Recalls 預約及催還
- Inter-Branch Book Delivery 校內館際書籍傳遞
- Kindle E-book Reader Lending Service Kindle 電子書閱讀器借用服務
- Course Reserves 指定參考

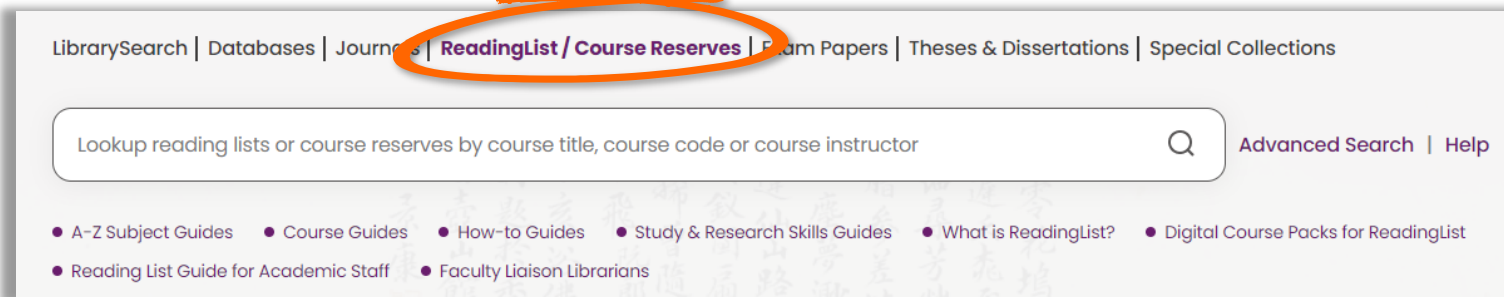

- Email notifications 電郵通知書
 - All library notices, including coming due alert, due date alert, hold pickups, recalls, overdues, hold cancellation, borrow and return receipts, are sent to library users via email only.
圖書館的電郵通知書，包括「即將到期」、「到期」、「借取預約資料」、「催還」、「逾期」、「取消預約資料」、「借出」及「歸還」的通知，只會以電郵發送給圖書館讀者。
 - For CUHK students: via your email address provided by the ITSC
中文大學學生：發送至中大資訊科技服務處為學生提供的電郵地址



Hong Kong Academic Library Link (HKALL) 港書網

Eligible Users 符合資格的讀者	Hold/Loan quota 預約/借書限額	Loan Period 借閱期限	Maximum Loan Period* 最長借期
Postgraduate students 研究生	15	30 days	90 days

Hong Kong Academic Library Link (HKALL) allows eligible library users to borrow circulating materials from participating libraries, to be delivered to CUHK. Users can identify and request circulating materials from the participating libraries anytime through the LibrarySearch. The requested materials will be delivered to any CUHK Library user selected for checkout at the library's service counter.

「港書網」容許符合資格的讀者，預約教育資助委員會屬下其他七所院校圖書館之流通館藏，及將館藏送遞至香港中文大學。讀者可在任何時間，透過「檢索易」查找及預約院校圖書館的流通館藏，所預約之館藏會被送至任何一間讀者指定之中大圖書館，以供讀者在服務臺借閱。

LibrarySearch | Databases | Journals | ReadingList / Course Reserves | Exam Papers | Theses & Dissertations | Special Collections

All



HKALL
 New Additions
 A-Z Subject Guides
 EndNote
 RefWorks
 My Library Record

Search HKALL via
LibrarySearch



HKALL
港書網

JOURNAL A-Z DATABASE SEARCH BROWSE READING LISTS HELP LIBRARY HOMEPAGE

HKALL

Advanced Search



Details: <https://www.lib.cuhk.edu.hk/en/use/interlibrary-loan/hkall>



Interlibrary Loan 館際互借

■ Interlibrary Loan & Document Delivery 館際互借及文獻傳遞服務

<https://www.lib.cuhk.edu.hk/en/use/interlibrary-loan/document-delivery>

- Details: Materials for loan, quota and cost, link for ILLiad, etc.
詳情：可借閱的資料、限額、收費及ILLiad系統等

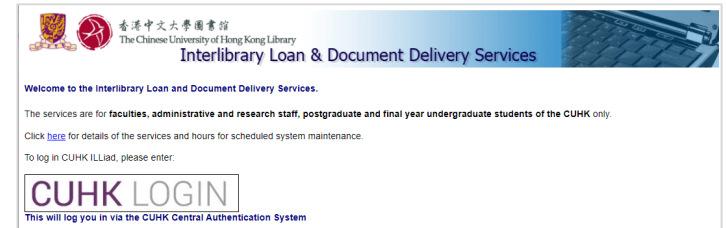

■ Using Other Libraries 使用其他圖書館

<https://www.lib.cuhk.edu.hk/en/use/other-libraries/julac>

- Access to Other UGC Libraries -- JULAC Library Card
使用其他大學教育資助委員會(UGC)院校圖書館 -- 聯校圖書證
- Free for staff and postgraduate students
教職員工和研究生可免費申請



LIBRARY FACILITIES 館內設施



Places to Study 研習空間

IT zone 電腦區



Group Study Rooms
研讀室



Reference Reading Room
參考閱覽室



Doctoral Study Rooms
博士生研讀室

24-Hour Study Facilities 24小時研習設施



Learning Garden, University Library
進學園 大學圖書館



LG/F, United College Library
聯合書院圖書館 地庫



**Late Reading Room,
Chung Chi College Library**
崇基學院牟路思怡圖書館 夜讀室



**Learning Commons,
6/F Wu Ho Man Yuen (WMY) Building**
學習共享空間 伍何曼原樓六樓



Medical Library
醫學圖書館



Architecture Library
建築學圖書館



Computing Facilities 電腦設施



Computers
電腦



Print, Copy, Scan
列印、影印、掃描



3D Printing Services
3D列印服務



3D Scanning Services
3D掃描服務



Wi-Fi
無線網絡



Application Software
應用程式軟件



Laptop Loans
手提電腦借用服務



Details: <https://www.lib.cuhk.edu.hk/en/use/facilities>



Learning Garden and MakerSpace 進學園及創客空間



Learning Garden 進學園

- on LG/F of UL 位於圖書館地庫
- a technology-rich learning environment and equipped with computer workstations for group work, and high-performance multimedia workstations for film editing and graphic design

提供配備科技充足的學習環境，和專為小組工作而設的完善電腦工作站，及專為電影剪輯和圖像設計而設的高性能多媒體工作站



Details: <https://www.lib.cuhk.edu.hk/en/libraries/ul/lg>



Learning Garden and MakerSpace 進學園及創客空間

MakerSpace 創客空間:

- in Learning Garden 位於進學園
- provides 提供:
 - 3D Printing and 3D Scanning
3D列印機和掃描儀器
 - Easy-to-Use Creative Media Production Studio
創意媒體製作間
 - AR & VR Equipment and Software
增實境和虛擬實境的設備及軟件
 - Laser Cutting & UV Printing
激光切割和UV印刷
 - Software for Image Editing, 3D Modeling, etc.
圖像編輯、3D建模等軟件

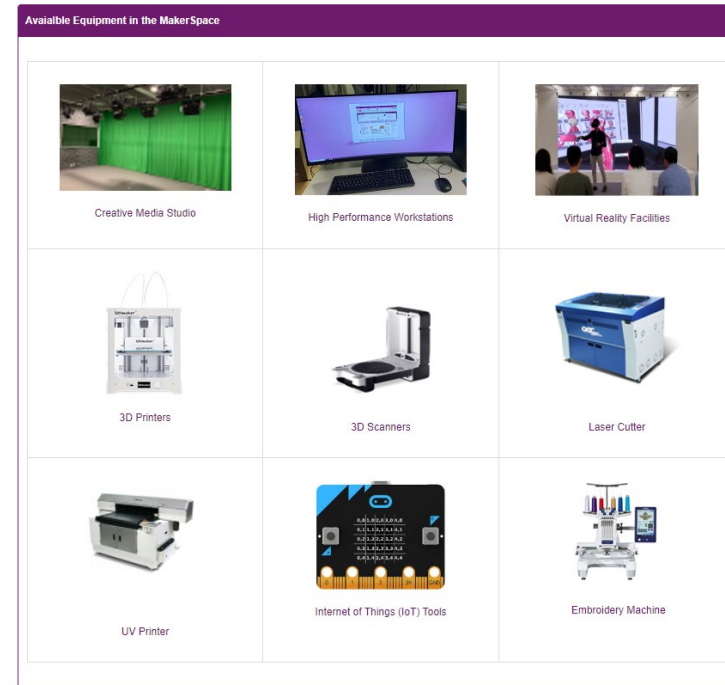
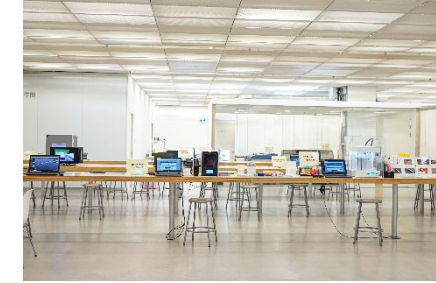
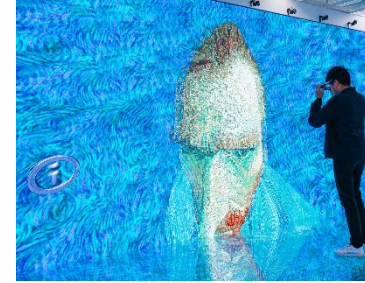

Details: <https://libguides.lib.cuhk.edu.hk/makerspace>



RESEARCH SUPPORT 研究支援



Research Consultation Service 研究諮詢服務

- Professional librarian 專業圖書館員
 - Faculty Liaison Librarians 院系聯絡主任 <https://www.lib.cuhk.edu.hk/en/learning/faculty-liaison>
- Assist research projects 研究主題協助
- One-on-one service 一對一的服務
- To request appointment, complete online Research Consultation Request Form
若要預約此服務，請填寫線上預約研究諮詢申請表

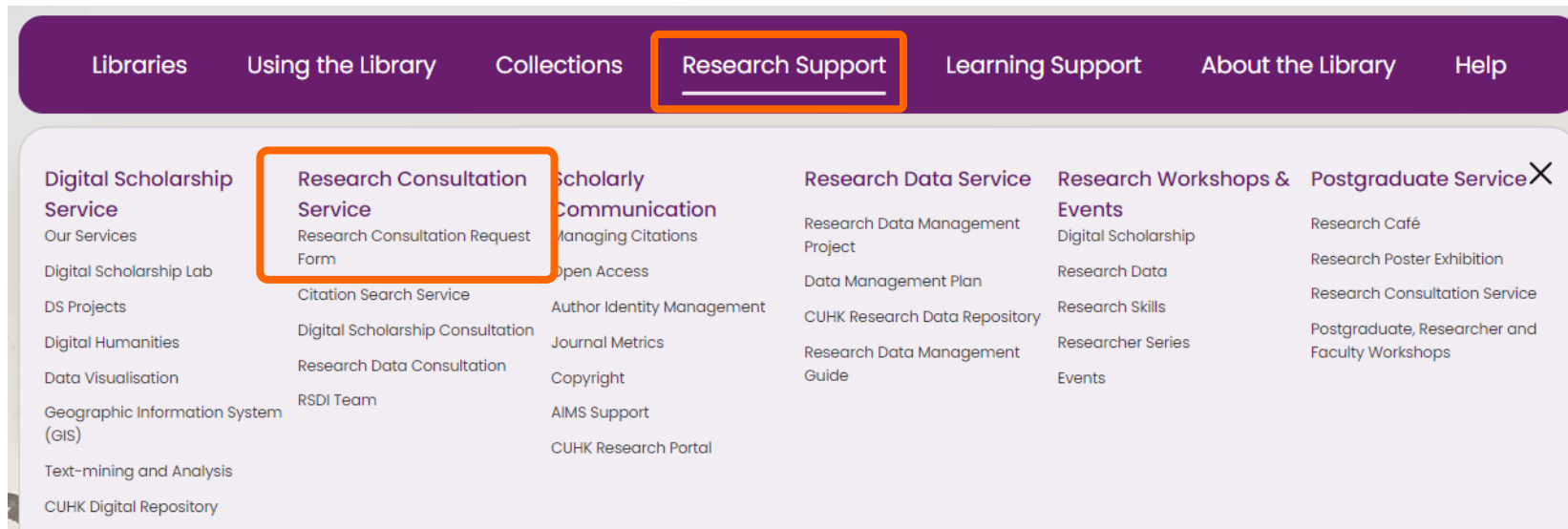

Details: <https://www.lib.cuhk.edu.hk/en/research/consultation>



Digital Scholarship Services 數碼學術研究服務

Services to support and promote digital scholarship research 支援及推廣數碼學術研究的服務

- Digital scholarship research projects support
數碼學術研究項目支援
- Digital Scholarship Lab on G/F, University Library
數碼學術研究室 位於大學圖書館地下
<https://www.lib.cuhk.edu.hk/en/libraries/ul/dsl>
- Software & tools 軟件及工具
- Training workshops and seminars 講座及研討會
- Consultation on Digital Scholarship Research 數碼學術研究諮詢服務
- Data services 數據服務
- Promotion events 推廣活動
- Learning resources 學習資源

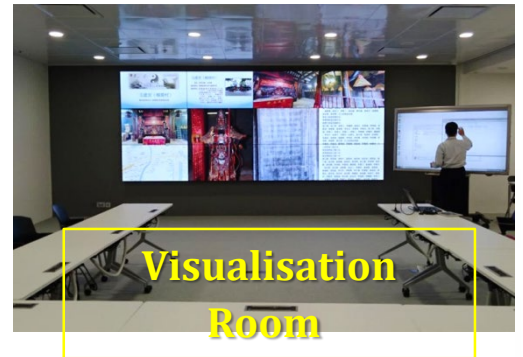

Details: <https://www.lib.cuhk.edu.hk/en/research/digital-scholarship>



Managing Citations 引文管理

Citation Management Tools 引文管理工具

- The Library supports these citation management tools 圖書館支援以下引文管理工具:



Workshops on RefWorks and EndNote

使用 RefWorks and EndNote 的講座

<https://www.lib.cuhk.edu.hk/en/learning/pg-researcher-faculty-workshops>



Details: <https://www.lib.cuhk.edu.hk/en/research/citation/tool>



CUHK Research Portal

香港中文大學學術研究文庫

- Gathers information on research outputs, grants, projects and the scholarly activities of CUHK researchers

集合香港中文大學研究人員的研究成果、資助項目、研究項目和學術活動的信息

- Wherever possible, the CUHK Research Portal **offers open access** to CUHK's research outputs
可行的情況下開放中大的研究成果

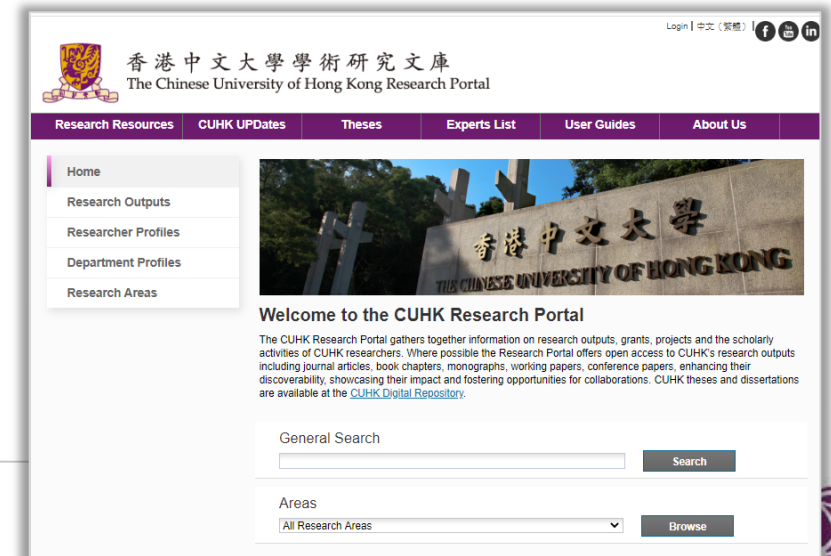

Details: <https://aims.cuhk.edu.hk>



POSTGRADUATE WORKSHOP SERIES

研究生講座與研習班



Workshops and Seminars 講座及研習班

To enhance your skills and your postgraduate experience
增進研究生技巧與體驗的講座及研習班

Exploring Databases

Citation Management Tools

Data Management Plans

Finding Theses and Dissertations

Designing an Oral Defence

Poster Design

Structuring a Thesis Introduction

Open Access Publishing

Presentation Skills

Writing Thesis Abstract

Author Identifiers

Oral Presentation Skills in
Chinese

Chinese Thesis Writing Skills

Qualitative Data Analysis

* Discipline-specific courses

Writing and Publishing Scientific
Papers

Understanding Research Data
Management



Workshops and Seminars 講座及研習班

<https://www.lib.cuhk.edu.hk/en/learning/pg-researcher-faculty-workshops>

Home > Learning Support

Postgraduate, Researcher and Faculty Workshops

Overview | Undergraduate Workshops | Postgraduate, Researcher and Faculty Workshops | Previous Workshops | Self-Learning Tools



Workshops and talks on research skills, strategies for publishing in academic journals, research alert, citation management, researcher identifier creating and research impact showcasing are provided to CUHK postgraduates, researchers and faculty members. In addition, discussion workshops such as successful presentations, thesis writing tips and scientific writing are also organized. Attendance proof may be issued on request.

- **Postgraduate Survival Skills Workshops**
 - Sharpening Your Research Skills
 - Managing Citations for Your Research
 - Thesis Writing Tips
 - Scientific Writing Workshops
 - Oral Defence Workshop
- Researcher Workshops
- Digital Scholarship and Research Data Workshops
- Improving Postgraduate Learning (IPL) Courses (Organized by Graduate School and CLEAR)
- Request a Seminar



Discover Research Information at Your Discipline Courses

in Improving Postgraduate Learning (IPL) 2022-2023

organised by Graduate School

Designed for ALL postgraduate students.

These are discipline-specific courses focusing on discovering up-to-date scholarly and research information that are not available elsewhere. They are HIGHLY RECOMMENDED to enhance your research information skills.

Objective

At the end of the course, participants are able to:

- Have an overview of the key resources including both print and electronic provided by the Library and beyond
- Select resources relevant to their research
- Conduct effective search of research information in their discipline
- Assess the significance of the research information found



Discover Research Information at Your Discipline

Discover Research Information at	Date & Time	For	Venue
Arts	30 Aug 2022 (Tue) 6:30 p.m. – 9:00 p.m.	ALL postgraduate students in Arts	Online via Zoom
Business Administration	17 Sep 2022 (Sat) 9:30 a.m. – 12:00 noon	ALL postgraduate students in BA	
Education	13 Sep 2022 (Tue) 6:30 p.m. – 9:00 p.m.	ALL postgraduate students in Education	
Engineering	5 Sep 2022 (Mon) 6:30 p.m. – 9:00 p.m.	ALL postgraduate students in Engineering	
Medicine	14 Sep 2022 (Wed) 6:30 p.m. – 9:00 p.m.	ALL postgraduate students in Medicine	
Science	9 Sep 2022 (Fri) 6:30 p.m. – 9:00 p.m.	ALL postgraduate students in Science	
Social Science	15 Sep 2022 (Thu) 6:30 p.m. – 9:00 p.m.	ALL postgraduate students in Social Science	
Law	8 Oct 2022 (Sat) 9:30 a.m. – 12:00 noon	ALL postgraduate students in Law	
Chinese Law	24 Sep 2022 (Sat) 9:30 a.m. – 12:00 noon	ALL postgraduate students in Law	



Managing & Creating Reference Citations with RefWorks Courses

in IPL 2022-2023 organised by Graduate School



Designed for

ALL postgraduate students of various disciplines. **HIGHLY RECOMMENDED.**

Objective

At the end of the courses, participants are able to:

- Create and format in-text citations and bibliographies for their papers using the two Reference Management Tools, EndNote and RefWorks
- Create personal references database by importing references from online databases and other sources
- Manage the references in the personal database



Managing and Creating Reference Citations with Reference Managing Tools in IPL 2022-2023 organised by Graduate School

Mainly demonstration on:

- Setting up an EndNote/RefWorks account
- Importing references from online databases
- Creating groups (EndNote) / folders (RefWorks)
- Creating a bibliography in a variety of formats/styles
- Using EndNote/RefWorks with MS Word

Participant are advised to use a computer during the online course for following the demonstration.

Managing & Creating Reference Citations with	Date & Time	For	Venue
EndNote	19 Sep 2022 (Mon) 6:30 p.m. – 9:00 p.m.	ALL postgraduate students of various disciplines.	Online via Zoom
RefWorks	27 Sep 2022 (Tue) 6:30 p.m. – 9:00 p.m.		



Basics of Research Data Management (e-learning module) in IPL 2022-2023 organised by Graduate School

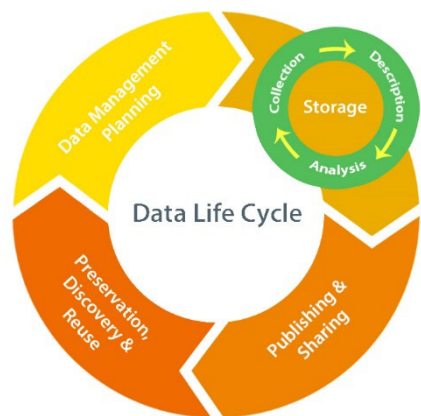

Designed for

ALL research postgraduate and taught doctoral students (admitted in 2022/23 or after). Students are required to complete this online course in their 1st year of studies.

Objective & Brief Description

Research Data Management (RDM) is of growing importance throughout the research life cycle. This self-learning online course covers an overview of RDM, Data Management Plan, data deposit, and data ethics. After completion of this course, students will be able to understand the purpose and principles in research data management.



Basics of Research Data Management (e-learning module) in IPL 2022-2023 organised by Graduate School

Blackboard®

Structure

Web-based course and examination

Completion requirements

To complete this compulsory course, student must:

- 1) go through ALL the materials online, AND
- 2) pass the online examination.



Research Data Management for Your Discipline (workshops) in IPL 2022-2023 organised by Graduate School

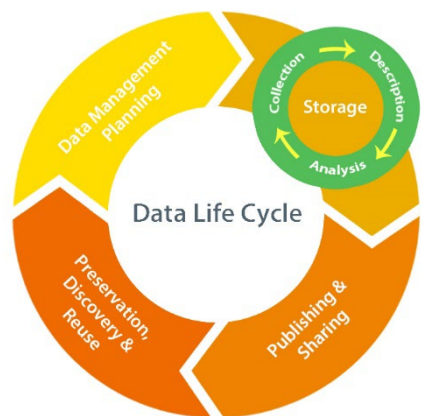

Designed for

ALL postgraduate students who need to manage data for their research. These are discipline-specific courses focusing on research data management. They are optional but **HIGHLY RECOMMENDED** to enhance your research skills in managing research data.

Objective

At the end of the courses, participants are able to:

- Understand the purpose and principles in research data management
- Demonstrate the skills in managing research data
- Create Data Management Plans with DMPTool
- Select a data repository for data deposit

Structure

Online via Zoom



Research Data Management for Your Discipline (workshops) in IPL 2022-2023 organised by Graduate School

The workshops for different disciplines will cover:

- Key concepts of research data management
- Features of Data Management Plans (DMPs) and using DMPTool to create DMPs
- Data repositories and dataset deposit in the CUHK Research Data Repository
- Data collection and reuse (according to disciplines)
- Data ethics (according to disciplines)

Research Data Management for	Date & Time	For	Venue
Arts and Education	15 Oct 2022 (Sat) 3:00 p.m. – 5:00 p.m.	All postgraduate students in Arts and Education	Online via Zoom
Engineering	7 Oct 2022 (Fri) 6:00 p.m. – 8:00 p.m.	All postgraduate students in Engineering	
Medicine	21 Oct 2022 (Fri) 6:00 p.m. – 8:00 p.m.	All postgraduate students in Medicine	
Science	14 Oct 2022 (Fri) 6:00 p.m. – 8:00 p.m.	All postgraduate students in Science	
Business, Law, Social Science, and Inter-faculty	28 Oct 2022 (Fri) 6:00 p.m. – 8:00 p.m.	All postgraduate students in Business, Law, Social Science, and Inter-faculty	
Multi-disciplines	13 Jan 2023 (Fri), 6:00 p.m. - 8:00 p.m.	All postgraduate students	



IPL Courses Registration

Registration Period: 15 Aug 2022 – 3 days before course start

First-come-first-served

Registration and details:

<http://www.cuhk.edu.hk/clear/prodev/ipl.html#registration>



Research Café 研究茶座

- A series of informal events for postgraduates and researchers across disciplines to get together and for research students to present their research work
一系列輕鬆互動的交流活動，讓研究式課程研究生簡報自己的研究
- Features 活動特色：
 - 15-minute presentations on a theme from research students in various disciplines
在一個主題上由不同學科的研究生作15分鐘的研究專題簡報
 - Discussion facilitated by a moderator
活動主持人協助交流討論
 - Feedback on presentation skills
簡報技巧的建議
 - Sharing by scholars with expertise on cross-disciplinary research
學者分享跨科研究的經驗和心得
 - Research students are very welcome to volunteer to present your research via this form: <https://www.lib.cuhk.edu.hk/en/research/rsdi-cafe-abstract-form>



Details: <https://www.lib.cuhk.edu.hk/en/research/research-cafe>



Research Poster Exhibition 研究海報展覽

- For facilitating postgraduates to broaden the reach of their own research to the university community and to enhance poster presentation skills
旨在促進研究生向大學社羣介紹他們的研究專題，及為參展者提供機會提高海報簡報技巧
- Features 特色:
 - Research posters in different disciplines are welcome. 歡迎各科的研究海報參展
 - Selected research posters are displayed in the University Library and YIA Park.
入選海報於大學圖書館及康本國際學術園展出
 - Oral presentation of research content and answering judges' questions by participants 參展者回答評判的問題
 - Awards 獎項

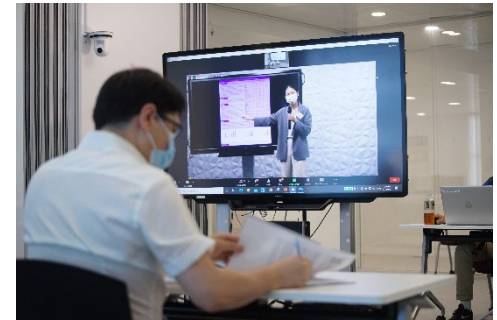

Details: [https:// www.lib.cuhk.edu.hk/en/research/poster-exhibition](https://www.lib.cuhk.edu.hk/en/research/poster-exhibition)



Tips for Postgraduate 研究生小貼士

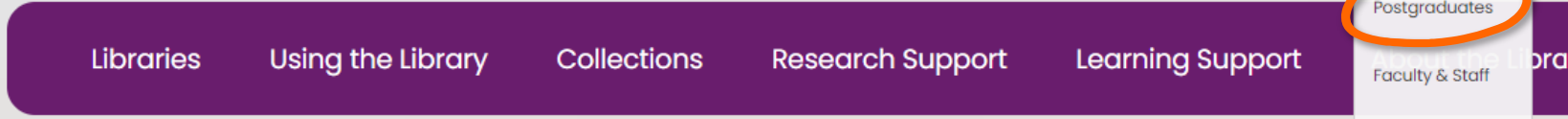
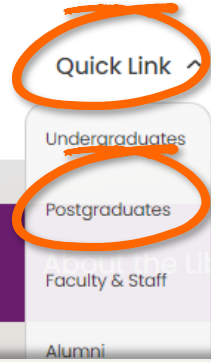

Home

Postgraduates

Orientation | Library Workshops | Self-Learning Tools | Learning Materials | Postgraduate Service | Teaching Support | Managing Citations | Learning Garden & MakerSpace

Tips for Postgraduates

- JOIN Library Postgraduate Orientation to get started of your postgraduate study
- JOIN Library Postgraduate Workshops to sharpen your research and writing skills
- BOOK a Research Consultation Session for professional help on a research topic
- SEARCH the Electronic Theses and Dissertations Collection to find materials for your research
- USE relevant Citation Tools to handle citations of your research papers
- RESERVE the Digital Scholarship Lab to conduct digital scholarship research
- APPLY for a JULAC Library Card to gain access to other UGC Libraries
- USE Interlibrary Loan and Document Delivery Service to obtain materials for your research and study not owned by the Library
- RESERVE a Doctoral Study Room for your doctoral study
- INPUT your research outputs in CUHK Research Portal



Details: <https://www.lib.cuhk.edu.hk/en/information/postgraduates>



Social Media 社交媒體



Facebook 面書

<https://www.facebook.com/CUHKLibraries>



Instagram

<https://www.instagram.com/cuhklibraries/>



Twitter 推特

<https://twitter.com/CUHKLibraries>



YouTube

<https://www.youtube.com/user/CUHKLibraries>



Telegram

<https://t.me/CUHKLibraries>



We are here to help!

- **Question? Ask Us 查詢** <https://libanswers.lib.cuhk.edu.hk/>
Popular topics, **FAQ**, and recent questions

- **Contact Us 聯絡我們**

Online form 網上表格 : <https://www.lib.cuhk.edu.hk/en/contact-us>



library@cuhk.edu.hk



Zoom-with-a-Librarian 圖書館線上查詢服務

(Mon to Fri: 2 p.m. – 5 p.m.)



5578 8898 (Mon to Fri: 9 a.m. – 5 p.m.)



Help Desk, 1/F, University Library (Tel. : 3943 7305)



Make an appointment for the Research Consultation Service

預約研究諮詢服務

- **Live Chat** 網上即時參考諮詢服務



Live chat with a librarian without coming to the Library (Mon to Fri: 2 p.m. – 5 p.m.)



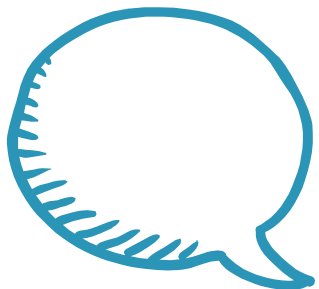

Thanks!

Any questions?

